

### SECTIONS

One T5, T5HO Lamp or Two T8 Lamps

End Cap Options

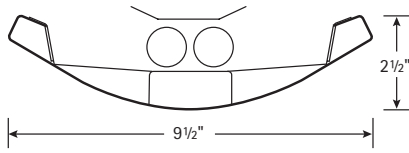

Cross Section

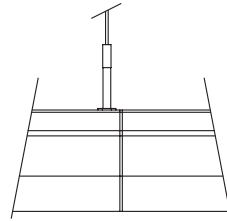

Connection Section

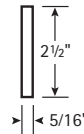

Flat

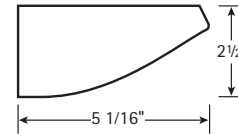

Bull Nose

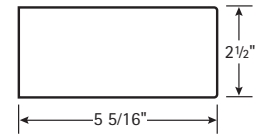

Shallow

### BOTTOM VIEW



Solid Housing

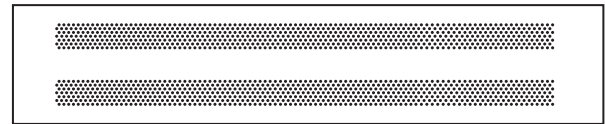

Perforated Housing

### SINGLE MOUNTING

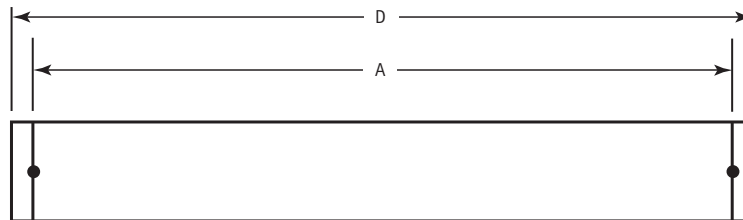

4', 8', 12'

### ROW MOUNTING

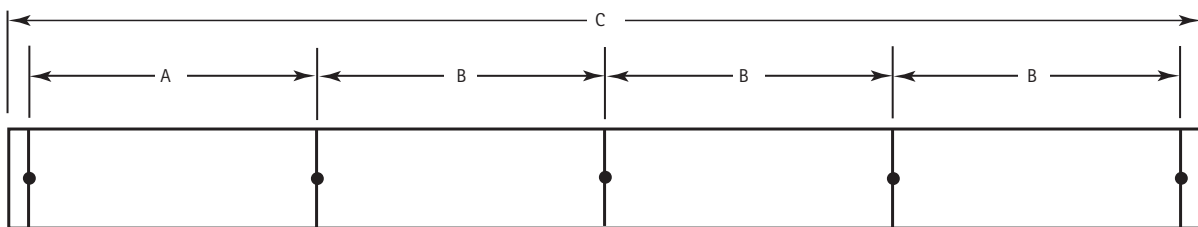

4', 8', 12'

### DATA CHART

Nominal Length	Approx. Weight		A	B	C	D
	1-lamp	2-lamp				
4'	15.8 lbs.	18.1 lbs.	47 1/4"	48"	192 5/8"	48 5/8"
8'	28.3 lbs.	30.6 lbs.	95 1/4"	96"	384 5/8"	96 5/8"
12'	38.5 lbs.	43.1 lbs.	143 1/4"	144"	576 5/8"	144 5/8"

Note: Suspension data is computed using the standard aircraft cable assembly. The use of rigid stems will yield different data. Please consult factory for stem data.

**SUSPENSION ATTACHMENT**
**Suspension Instructions:**

1. Set bottom nuts to desired fixture height.
2. Adjust upper nuts for a minimum of  $\frac{3}{8}$ " between upper and lower nuts.
3. Slide cable hanger into hanger slots.
4. Secure and tighten upper nuts.

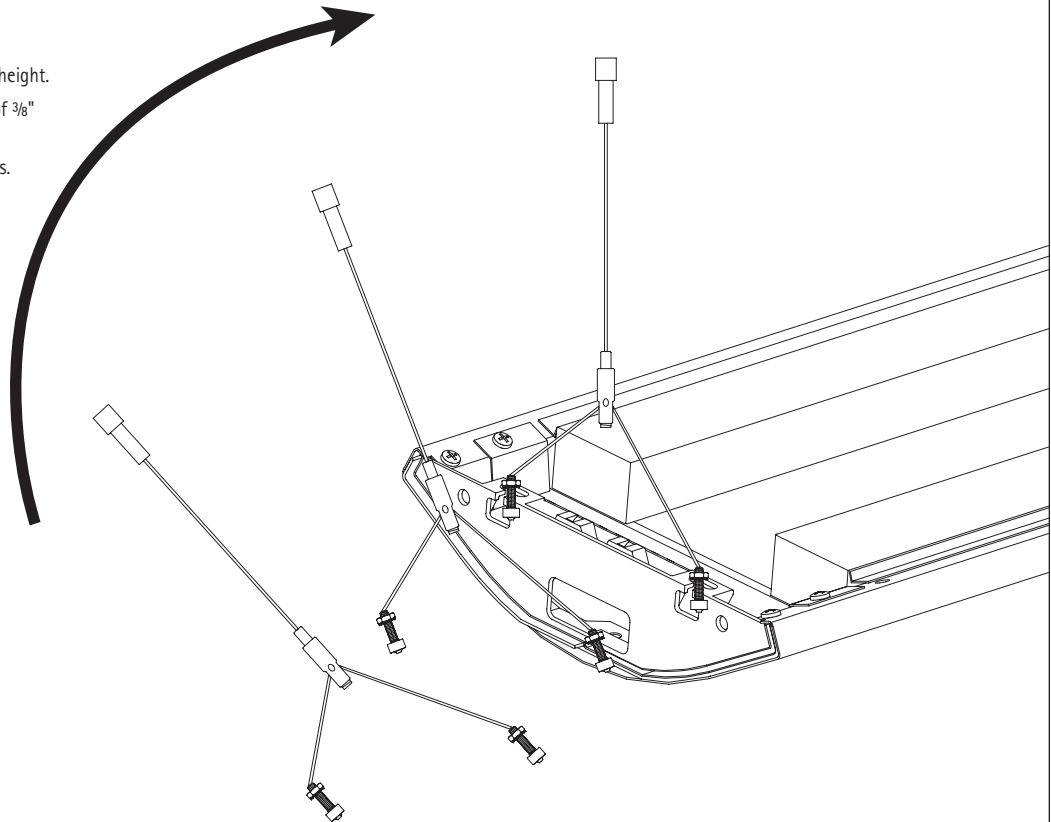
**FIXTURE CONNECTIONS**
**Connection Instructions:**

1. Install first fixture of row with two hangers.
2. Slide inner die cast plates together.
3. Secure fixture joints with two bolts and nuts and attach hanger at opposite end.
4. Repeat steps 2 and 3 until row is complete.
5. At each end of the row, attach and align end cap with two screws.

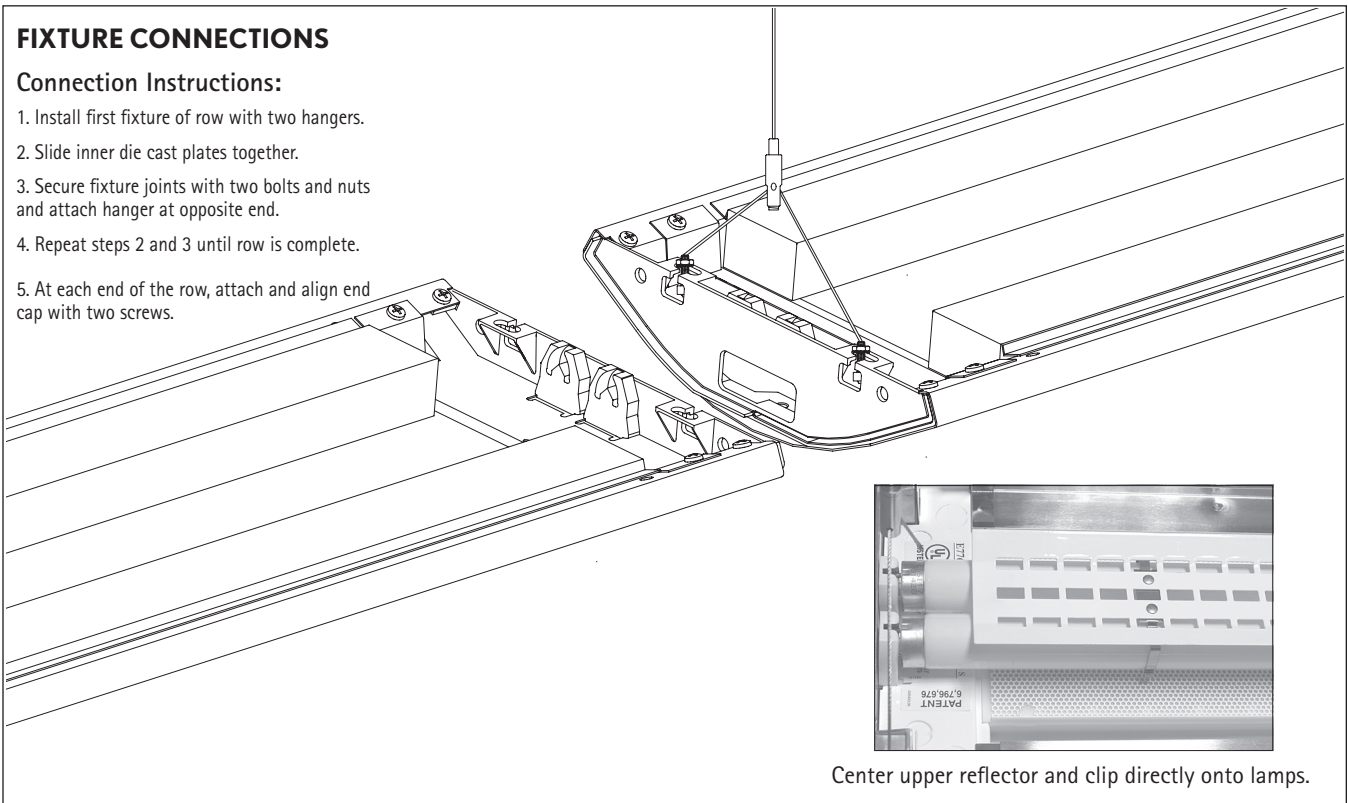

Center upper reflector and clip directly onto lamps.