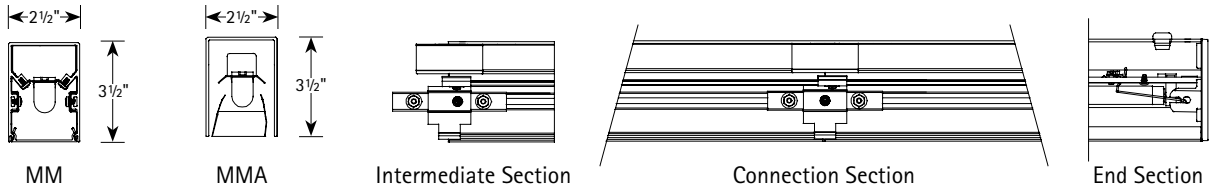
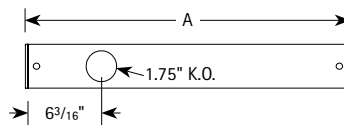
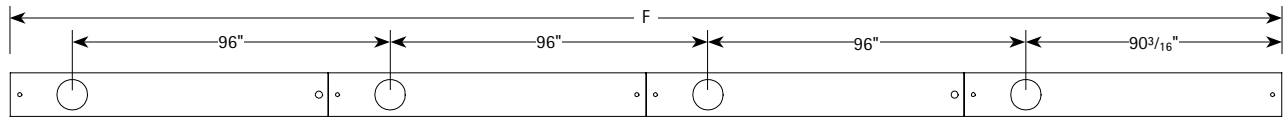
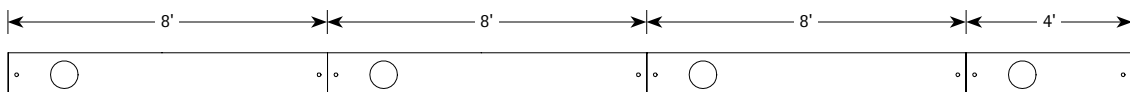

CROSS SECTIONS

BOTTOM VIEW

 Single
 (Shown with Lens)

SINGLE MOUNTING (TYPICAL)

ROW MOUNTING

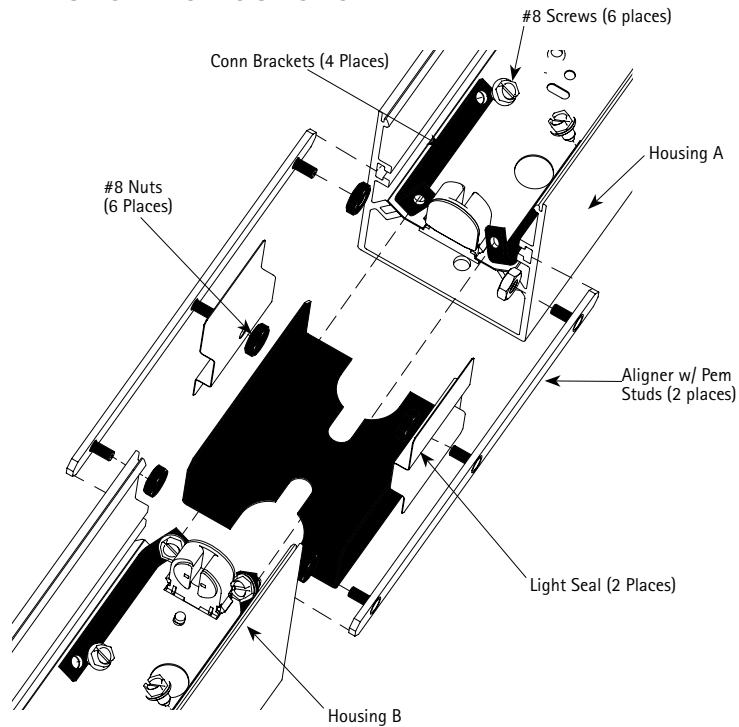
FACTORY STANDARD (TYPICAL ROW WITHOUT ENDCAPS)

DATA CHART

Nominal Length	Weight	A	F
4'	16 lbs.	48 ³ / ₈ "	192 ³ / ₈ "
8'	28 lbs.	96 ³ / ₈ "	384 ³ / ₈ "
12'	40 lbs.	144 ³ / ₈ "	576 ³ / ₈ "

CONNECTION INSTRUCTIONS



1. Attach connector brackets to reflector on each housing using the #8 screws. Ensure the angles are in the same direction on each housing. (4 total)
2. Insert Top Light Seal halfway into one of the Housings.
3. Insert Aligner with Pem Studs into the "C" channel slots on one of the housings (2 total)
4. Use the #8 nuts to secure the aligner to the housing A. (2 total)
5. Attach each Light Seal to the Aligner using the #8 nuts. Do not tighten the nut at this point. (2 total)
6. Butt Housing B against Housing A while engaging Top Light Seal and electrically connecting in-row wiring.
7. Engage the connector brackets with the screws provided. Tighten the screws until the housings are pulled together.
8. Secure the Aligner in Housing B with #8 nuts provided and tighten.
9. Tighten the nuts on the side light shields.