



Fig. M - Front of Master On/Off Switch



Fig. R - Front of Row On/Off Switch



Fig. B - Back of Switch without cables  
Example shown: Row 1 Switch

## DESCRIPTION

The A+CLASS™ Master Control and Row Control Switches are designed to provide a user interface and on/off control of systems operating on Class 2, low voltage circuitry. Master and/or Row Control Switches are provided as part of the A+CLASS™ system. See *INCLUDED COMPONENTS* below for additional switch station component information. Configurations of A+CLASS™ Master and/or Row Control switches are provided based on customer order.

## SPECIFICATIONS

- Electrical Ratings: Each switch: 100mA @ 30VDC Max
- Accepts standard decorator style wall plate, provided with A+CLASS™ system
- UL and cUL listed when installed as part of a complete A+Class™ System
- 5-year warranty when installed as part of a complete A+Class™ System

## PRECAUTIONS

- **CAUTION: FOR USE WITH CLASS 2, LOW VOLTAGE SYSTEMS ONLY. DO NOT USE IN HIGH VOLTAGE APPLICATIONS.**
- Read and understand all instructions before beginning installation.
- NOTICE: For installation by a licensed electrician in accordance with National and/or local Electrical Codes.
- NOTICE: For indoor use only.
- **CAUTION: USE COPPER CONDUCTOR ONLY.**
- Confirm device ratings are suitable for application prior to installation. Use of device in applications beyond its specified ratings or in applications other than its intended use may cause an unsafe condition and will void manufacturer's warranty.
- NOTICE: Do not install if any damage to product is noticed.
- ALL EXCESS CAT5 CABLE MUST BE REMOVED FROM WALL BOX PRIOR TO INSTALLATION. Connection between CAT5 cable and switch connection port must remain straight and true without interference or pressure from excess or misaligned cable.

## INCLUDED COMPONENTS

### 1. Classroom Control Module (CCM)

### 2. Switch Stations

- Master On/Off: Turns all rows of lighting on or off from a single switch
- Row 1, Row 2, Row 3, Row 4: Turns one row of lighting on or off. Each row requires a separate switch. A+CLASS will support up to four individual rows of lighting. Row controls are typically ganged together with only one home run back to the CCM per gang.

### 3. 50' Yellow CAT5 Cable

- One per Master On/Off switch station
- One per Row single or ganged switch station

### 4. 3" Yellow CAT5 Jumper Cable (Row Gangs Only)

- Not required for Master On/Off switch station
- One per each jump required
  - ▣ 2-Row switch gang: 1 jumper
  - ▣ 3-Row switch gang: 2 jumpers
  - ▣ 4-Row switch gang: 3 jumpers
- If multiple Row stations are used, the appropriate number of jumpers will be provided

### 5. Switch Plate(s) for single or multi-gang as dictated by customer order

### 6. A+CLASS™ lighting fixtures (shipped separately)

## SWITCH STATION IDENTIFICATION

Side Label P/N	Back Label	No. of Buttons	Button Label(s)	Function
APCS-MC	MC	2	ON, OFF	On/Off control for all rows of general and/or A/V lighting
APCS-RCR1	RCR1	1	ROW 1	On/Off control for one row of general and/or A/V lighting designated Row 1
APCS-RCR2	RCR2	1	ROW 2	On/Off control for one row of general and/or A/V lighting designated Row 2
APCS-RCR3	RCR3	1	ROW 3	On/Off control for one row of general and/or A/V lighting designated Row 3
APCS-RCR4	RCR4	1	ROW 4	On/Off control for one row of general and/or A/V lighting designated Row 4

## INSTALLATION INSTRUCTIONS

1. Prepare the installation site, as necessary, to install the switch.
2. Plug the 50' Yellow CAT5 cable into the Yellow Master/Row Control connector on the Classroom Control Module (See Figure 1). Each CAT5 connection will operate properly from any available Yellow Master/Row Control port. Multiple connections are required under the following circumstances.
  - a. When multiple Master On/Off controls are used and each has a home run back to the CCM.
  - b. When a Master On/Off control is used in conjunction with a gang of Row on/off controls.
  - c. When multiple Row control gangs are used in the same classroom and each has a home run back to the CCM.
3. Route the Yellow cable from the Classroom Control Module to the Master Control Switch or Row Control Switch. If routing multiple switch stations, up to four connections may be made as home run connections. *Note: Low voltage wiring must be isolated from line voltage wiring. Consult National and Local Electrical Codes for conduit requirements.*
4. Plug the Yellow cable into the Master Control Switch or Row Control Switch (See Figure 2). Verify solid snap-in connection.
5. If multiple switches are ganged together, daisy-chain them together using 3" Yellow jumper cable (See Figure 3). Verify solid snap-in connection(s).
6. Remove excess cable from wall box prior to insertion of switch(es). CAT5 connection to the switch must remain straight, true, and free of pressure or interference from excess cable in box. (See Figure 4). Test functionality of switch prior to installing the switches into the electrical box.
7. Perform system setup and/or programming activities as applicable in accordance with the instructions of the CCM (Classroom Control Module).
8. Verify switch functionality by pressing the switch button(s) and confirm proper system response.



Fig. 1



Fig. 2



Fig. 3

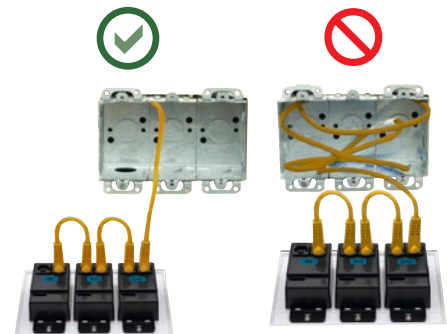
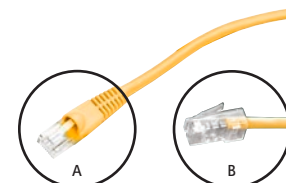

Fig. 4

**NOTE:** EasyConnect cord upgrade may be provided. EasyConnect can be identified in Figure 5.

## TROUBLESHOOTING TIPS

1. Check for solid connections between all components.
2. Ensure power to CCM is engaged.
3. Ensure wall box does not include excess cable; CAT5 connections must be straight and true without interference. See step 6 above.
4. Consult CCM programming manual for additional assistance.



1. (Cat cable end may look like A or B)

Fig. 5