

LEX/MAX

Lexim/Maxim



CURVES

FEATURES

- One, two, or three T5 or T5HO lamps in a dedicated housing and optical system
- Sleek low profile appearance in oval (LEX) or triangular (MAX) shape
- Heavy 20-gauge steel construction for excellent housing rigidity
- Three reflector systems provide high efficiencies with excellent distribution choices
- Unique tabbing system allows quick and easy installation when placing fixtures in rows
- Modular lengths and suspension points for ease of installation
- All painted parts are treated with five stage phosphate bonding process and finished with matte white powder coat
- UL listed 1598. Damp label available on most models

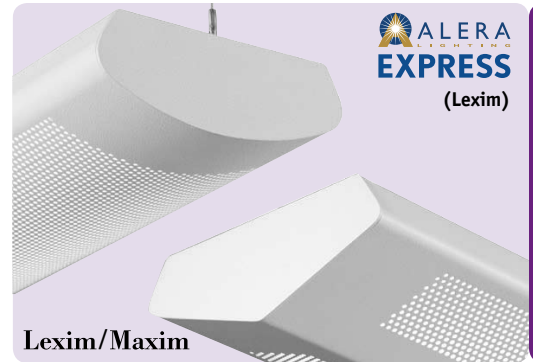

Lexim/Maxim

ORDERING INFORMATION

| | | | | | | | | | | | |
|--|--|-------------------------------------|--|---|--|---|--|--|--|---|--|
| MODEL | | HOUSING TYPE | | SUSPENSION LENGTH (CM) | | VOLTAGE | | FINISH | | OPTIONS | |
| LEX Lexim (Oval) | | S Solid | | 48 48" | | U 120V-277V | | MW Matte White (Std.) | | HRF High Efficiency Reflector | |
| MAX Maxim (Triangular) | | PERF Perforated | | 96 96" | | 120 120V | | GW Gloss White | | LR Left/Right Switching | |
| | | AP All Perforated (2-Lamp LEX only) | | 144 144" | | 277 277V | | ZT ZET Metallic Silver | | IBOB Inboard/Outboard Switching, 3-Lamp Units | |
| | | HLST Horizontal Slot | | Other lengths available on request. | | 347 347V | | See page 183 for other color selections. | | EL One Emergency Battery Pack ^{1,2} | |
| | | VLST Vertical Slot | | | | | | | | F5841 With T5/T5HO 4100K Lamp Installed | |
| | | | | | | | | | | F5835 With T5/T5HO 3500K Lamp Installed | |
| | | | | | | | | | | EMC One Emergency Circuit ^{1,2,3} | |
| | | | | | | | | | | NLC Night Light Circuit ^{1,2,3} | |
| | | | | | | | | | | GLR Fast Blow Fuse | |
| | | | | | | | | | | GMF Slow Blow Fuse | |
| | | | | | | | | | | TBAR T-Bar Mounting | |
| | | | | | | | | | | CSA UL listed or CSA certified for Canada | |
| | | | | | | | | | | DL Damp Label (Available on most models) | |
| | | | | | | | | | | WR White Reflector | |
| ROW LENGTH | | LAMP TYPE & PROFILE | | MOUNTING METHOD | | BALLAST | | | | | |
| 4 4' Single | | 1T5 1 T5 Lamp | | FCM18 Fixed Aircraft Cable Mount (Std.) 18" | | EP Electronic, Programmed Start (Std. for T5 & T5HO, optional for T8) | | | | | |
| 8 8' Single | | 2T5 2 T5 Lamps | | CM Adjustable Aircraft Cable Mount | | ED Electronic, Dimming (Must specify) | | | | | |
| 12 12' Single | | 3T5 3 T5 Lamps | | | | ESD Electronic, Step Dimming | | | | | |
| — Indicate row length over 8' in 4' increments | | 1T5HO 1 T5HO Lamp | | | | Unless specified, Alera will use fewest ballasts possible. | | | | | |
| Note: Rows over 12' will be configured by Alera. Example: 16' will be (2) 8'. Alternate configurations: contact factory. | | 2T5HO 2 T5HO Lamps | | | | | | | | | |
| | | 3T5HO 3 T5HO Lamps | | | | | | | | | |

¹Specify voltage. For additional, specify quantity before nomenclature (Example: 2EL120).
²Not available with all configurations; some limitations apply. Contact factory for details.
³One extra feed drop per row with through wiring. (Standard is one 4ft lamp per circuit.)

MOUNTING INFORMATION

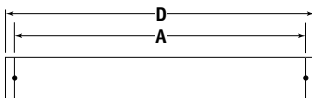

4', 8', 12' Single

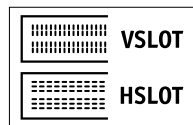

For exact slot patterns contact factory.

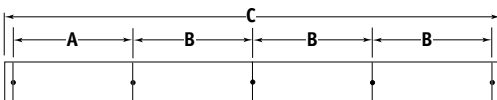

4', 8', 12' Rows

DATA CHART

| NOMINAL LENGTH | APPROX. WEIGHT (LBS.) | | | A | B | C | D |
|----------------|-----------------------|--------|--------|-------|------|-------|-------|
| | 1-LAMP | 2-LAMP | 3-LAMP | | | | |
| 4' | 10.5 | 11.2 | 12.5 | 47½" | 48" | 192½" | 48½" |
| 8' | 21.0 | 22.4 | 25.0 | 95½" | 96" | 384½" | 96½" |
| 12' | 31.5 | 33.6 | 37.5 | 143½" | 144" | 576½" | 144½" |

Note: Suspension data is computed using the standard aircraft cable assembly. The use of rigid stems will yield different data. Please consult factory for stem data.

CROSS SECTIONS

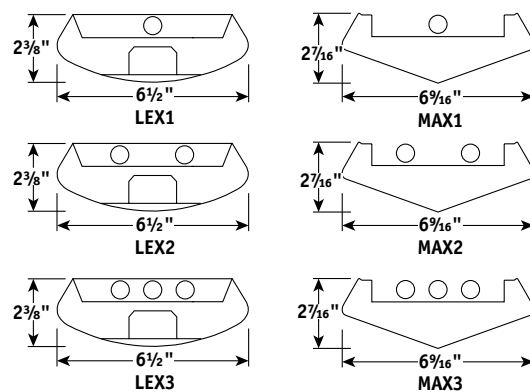

| | |
|-------------|-------------------|
| Name: | LEX-2T5HO-S-EP-WR |
| Test #: | 12905 |
| Efficiency: | 107.3% |
| LER: | 78 |

Definitions on page 182.

