

# NPLS

## Nevis Plus Liso

CURVES

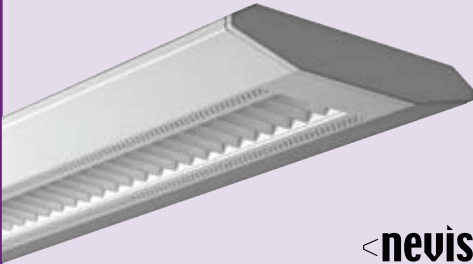

Shown with perforated housing, white cross baffle.

**nevis**  
PLUS LISO

### FEATURES

- Unique, interesting shape tapers down to  $\frac{13}{32}$ " for a minimalist, floating appearance
- Heavy 20-gauge construction provides excellent housing rigidity; patented die cast aluminum joiners ensure excellent row integrity (Patent# 6,796,676B2)
- Close-to-ceiling mounting 12" to bottom of housing
- Performance driven light delivery system creates smooth ceiling gradients on wide fixture spacings
- T5 or T5H0 one-lamp, T8 two-lamp cross sections
- Optional perforated housing
- Flat end caps standard ( $\frac{5}{16}$ " )
- Standard with white cross baffle and overlay
- Consistent, predictable mounting locations simplify installation
- UL listed 1598. Damp label available on most models

### ORDERING INFORMATION

NPLS - [ ] - [ ] - [ ] - CM [ ] - [ ] - [ ] - [ ] - [ ] - [ ]					
MODEL	HOUSING TYPE	SUSPENSION LENGTH (CM)	VOLTAGE	FINISH	OPTIONS
NPLS Nevis Plus Liso	Blank Solid (Std.) PFST Perforated Strip DPST Diamond Pattern Perforated Strip	12 12" (Std.) 18 18" 24 24" Other lengths available on request.	U 120V-277V 120 120V 277 277V 347 347V	MW Matte White (Std.) GW Gloss White ZT ZET Metallic Silver	LR Left/Right Switching (2-Lamp T8 only) EL One Emergency Battery Pack <sup>1, 2</sup> EMC One Emergency Circuit <sup>2, 3</sup> NLC Night Light Circuit <sup>2, 3</sup> GLR Fast Blow Fuse GMF Slow Blow Fuse TBAR T-Bar Mounting CSA UL listed or CSA certified for Canada DL Damp Label (Available on most models)
ROW LENGTH	LAMP TYPE & PROFILE	MOUNTING METHOD	SHIELDING	BALLAST	
4 4' Single 8 8' Single — Indicate row length over 8' in 4' increments	1T5 1 T5 Lamp 1T5H0 1 T5H0 Lamp 2T8 2 T8 Lamps	CM Adjustable Aircraft Cable Mount (Std.)	WCB White Cross Baffle RPF Regressed Perforated FPF Flat Perforated OA Opal Acrylic Lens A12 Pattern 12 Acrylic Lens LD Low Iridescent Semi-Specular Louver	E Electronic, Instant Start (Std. for T8) EP Electronic, Programmed Start (Std. for T5 & T5H0, optional for T8) ED Electronic, Dimming (Must specify) ESD Electronic, Step Dimming Unless specified, Alera will use fewest ballasts possible.	

Note: Rows over 8' will be configured by Alera. Example: 16' will be (2) 8'. Alternate configurations: contact factory.

<sup>1</sup>Specify voltage. For additional, specify quantity before nomenclature (Example: 2EL120).  
<sup>2</sup>Not available with all configurations; some limitations apply. Contact factory for details.  
<sup>3</sup>One extra feed drop per row with through wiring. (Standard is one 4ft lamp per circuit.)

### CROSS SECTIONS

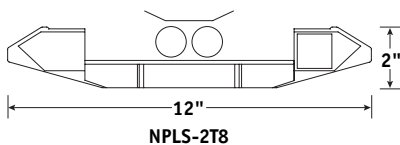
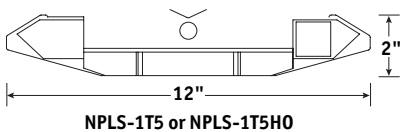

### MOUNTING INFORMATION

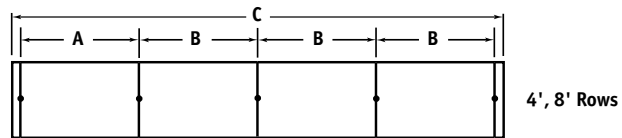
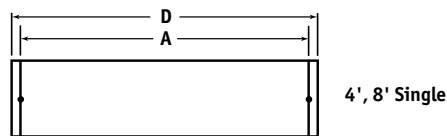

### DATA CHART

NOMINAL LENGTH	APPROX. WEIGHT (LBS.)		A	B	C	D
	1-LAMP	2-LAMP				
4'	17	17	47 $\frac{1}{4}$ "	48"	192 $\frac{5}{8}$ "	48 $\frac{5}{8}$ "
8'	28	28	95 $\frac{1}{4}$ "	96"	384 $\frac{5}{8}$ "	96 $\frac{5}{8}$ "

Note: Suspension data is computed using the standard aircraft cable assembly. The use of rigid stems will yield different data. Please consult factory for stem data. Calculations include flat end caps.

Name:	NPLS-1T5H0-WCB-EP
Test #:	14109
Efficiency:	90.7%
LER:	65

Definitions on page 182.

