

### FEATURES

- f Perforated housing provides a contemporary appearance for today's modern interiors
- f Indirect Luminaire
- f Product available with either T8, T5, or T5HO lamps
- f Heavy 20-gauge steel construction for excellent housing rigidity
- f Controls compatible
- f Unique connection method ensures housing seams are minimized and consistent
- f Specular reflector system provides maximum output with wide distribution

### SHAPE AND DIMENSIONS

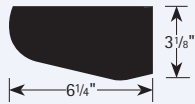

### PROJECT INFORMATION

Project Name	Type
Catalog No.	Date

### CONSTRUCTION

- Fixtures are available with one or two T8, T5 or T5HO lamps.
- The exact shape of the housing is maintained by the use of an inner structural plate at each socket location. The plate is welded into the housing, ensuring housing tolerances are consistent.
- End caps are 18-gauge construction and attach with nuts and bolts.
- The reflector is specular aluminum for wide distribution with maximum efficiency.

### FINISH

The housing and all painted parts are treated with a five stage phosphate bonding process before being finished. Parts are then finished with a white powder coat finish for maximum consistent coverage and longevity.

### MOUNTING

The WMP mounts directly to and is flush with the wall. A 2" x 3" cutout is provided in the unit to mount to a 2" x 4" junction box. If a junction box larger than 2" in diameter is used, a cover plate must be used to cover the exposed junction box. Key-hole slots on the back of the unit provide additional support. Consult the Installation Sheet for exact dimensions and locations of holes and slots.

### LABELS AND ELECTRICAL

- UL 1598 or CSA
- Prewired w/ T8, T5, or T5HO electronic ballast
- Quick connect plugs standard
- Damp label available on most models

Name:	WMP1T8-S-WM-E
Test #:	12589
Efficiency:	74.5%
LER:	56

### ORDERING INFORMATION

### EXAMPLE: WMP-8-2T8-PERF-WM-EU-MW

WMP		WM		VOLTAGE		FINISH	
MODEL	LAMP TYPE AND PROFILE	MOUNTING METHOD					
WMP Wall Mounted Perforated	1T5 One T5 Lamp 2T5 Two T5 Lamps 1T5HO One T5HO Lamp 2T5HO Two T5HO Lamps 1T8 One T8 Lamp 2T8 Two T8 Lamps	WM Wall Mount		U 120V-277V 120 120V 277 277V 347 347V		MW Matte White (Std.) ZT ZET Metallic Silver See MTX-1 for other color selections.	
ROW LENGTH	HOUSING TYPE	BALLAST	OPTIONS				
4 4' Single 8 8' Single – Indicate row length over 8' in 4' increments <b>Note:</b> Rows over 8' will be configured by Alera. Example: 16' will be (2) 8'. Alternate configurations: contact factory.	PERF Perforated S Solid AP All Perforated HSLT Horizontal Slot VSLT Vertical Slot	E Electronic, Instant Start (Std. for T8) EP Electronic, Programmed Start (Std. for T5 & T5HO, optional for T8) ED Electronic, Dimming (Must specify) ESD Electronic, Step Dimming Unless specified, Alera will use fewest ballasts possible.	GCO Grounded Convenience Outlet (120V only) PSW Pull Chain Switch UB Upper/Lower Switching EL Emergency Battery Pack <sup>1,2</sup> EMC One Emergency Circuit <sup>2,3</sup> NL Night Light Circuit <sup>2,3</sup> GLR Fast Blow Fuse GMF Slow Blow Fuse CSA UL listed or CSA certified for Canada DL Damp Label (Available on most models)				

<sup>1</sup> Specify voltage. For additional, specify quantity before nomenclature (Example: 2EL120).

<sup>2</sup> Not available with all configurations; some limitations apply. Contact factory for details.

<sup>3</sup> One extra feed drop per EMC. (For through wiring, contact factory.)

## CROSS SECTION

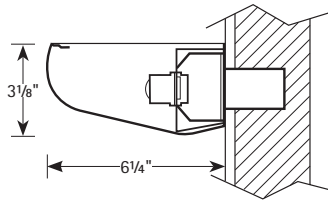

One Lamp

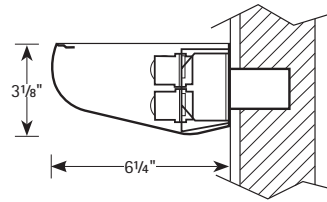

Two Lamp

## PHOTOMETRIC DATA

### LUMINAIRE DATA Test 12519

Luminaire	WMP-2T8-PERF-WM-E WMP Architectural Surface Mounted 6.5" x 48" 2-Lamp Wall Mount With Specular Reflector
Ballast	REL-2P32-SC
Ballast Factor	0.88
Lamp	F32T8
Lumens per Lamp	2900
Watts	57
Mounting	Wall
Shielding Angle	0° = 0 90° = 0
Spacing Criterion	0° = N/A 90° = N/A
Luminous Opening in Feet	Length: 3.38 Width: 0.17 Height: 0.00

### AVG. LUMINANCE (Candela/Sq. M.)

Angle	90.0	135.0	180.0	225.0	270.0
0	412	412	412	412	412
30	1017	952	368	87	87
40	1076	1003	342	98	318
45	1113	1007	344	212	371
50	1137	991	321	291	291
55	1143	980	294	261	229
60	1161	974	225	225	187
65	1152	931	177	177	177
70	1095	876	164	110	110
75	1158	724	145	72	145
80	1187	755	108	108	108
85	1505	860	215	215	215

### COEFFICIENTS OF UTILIZATION (%)

RCR	80					70					50					0
	RW	70	50	30	10	70	50	30	10	50	30	10	0			
1	56	53	51	49	48	46	44	42	32	31	30	1				
2	51	47	43	40	44	40	37	35	28	26	24	1				
3	46	41	37	33	40	35	32	29	24	22	20	1				
4	42	36	31	28	36	31	27	24	22	19	17	1				
5	39	32	27	23	33	27	23	21	19	17	15	1				
6	35	28	23	20	30	24	20	18	17	14	13	1				
7	33	25	21	17	28	22	18	15	15	13	11	0				
8	30	23	18	15	26	20	16	13	14	11	9	0				
9	28	21	16	13	24	18	14	11	12	10	8	0				
10	26	19	14	12	22	16	13	10	11	9	7	0				

### INDOOR CANDELA PLOT

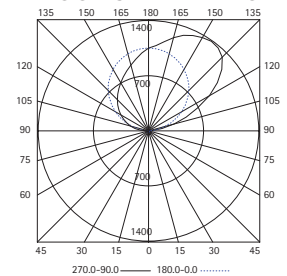

RCR = Room Cavity Ratio

RC = Effective Ceiling Cavity Reflectance RW = Wall Reflectance

### ZONAL LUMEN SUMMARY

Zone	Lumens	% Lamp	% Fixt.
0-30	20	0.3	0.5
0-40	34	0.6	0.9
0-60	66	1.1	1.8
0-90	88	1.5	2.3
90-120	893	15.4	24.0
90-130	1529	26.4	41.0
90-150	2787	48.0	74.8
90-180	3640	62.8	97.7
0-180	3727	64.3	100.0

### ENERGY DATA

Total Luminaire Efficiency	64.3%
Luminaire Efficacy Rating (LER)	58
Comparative Yearly Lighting Energy Cost per 1000 Lumens	\$4.14 based on 3000 hrs. and \$0.08 per KWH

Test Date 6/13/00

## PHOTOMETRIC DATA

### LUMINAIRE DATA Test 12626

Luminaire	WMP-1T5HO-PERF- WM-E WMP Curves 6.5" x 48" 1-Lamp Wall Mount With Specular Reflector
Ballast	FWTSD-155P
Ballast Factor	0.95
Lamp	F54T5
Lumens per Lamp	4400
Watts	61
Mounting	Wall
Shielding Angle	0° = 0 90° = 0
Spacing Criterion	0° = N/A 90° = N/A
Luminous Opening in Feet	Length: 3.38 Width: 0.17 Height: 0.00

### AVG. LUMINANCE (Candela/Sq. M.)

Angle	90.0	135.0	180.0	225.0	270.0
0	262	262	262	262	262
30	1017	930	238	65	65
40	1052	954	220	73	269
45	1060	954	212	159	371
50	1078	962	204	262	321
55	1078	947	163	294	261
60	1087	899	150	225	187
65	1064	887	133	177	177
70	1041	767	110	164	110
75	941	724	145	145	145
80	971	647	108	108	216
85	1290	860	215	215	215

### COEFFICIENTS OF UTILIZATION (%)

RCR	80					70					50					0
	RW	70	50	30	10	70	50	30	10	50	30	10	0			
1	80	76	73	70	69	66	63	61	45	44	42	1				
2	73	67	62	57	62	57	53	50	40	37	35	1				
3	66	58	52	47	57	50	45	41	35	32	29	1				
4	61	51	45	40	52	44	39	35	31	27	25	1				
5	55	46	39	34	47	39	34	29	27	24	21	1				
6	51	41	34	29	43	35	29	25	24	21	18	1				
7	47	36	29	25	40	31	26	22	22	18	15	1				
8	43	33	26	21	37	28	23	19	20	16	13	0				
9	40	29	23	19	34	25	20	16	18	14	12	0				
10	37	27	21	16	32	23	18	14	16	13	10	0				

### INDOOR CANDELA PLOT

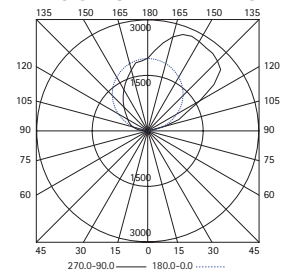

RCR = Room Cavity Ratio

RC = Effective Ceiling Cavity Reflectance RW = Wall Reflectance

### ZONAL LUMEN SUMMARY

Zone	Lumens	% Lamp	% Fixt.
0-30	16	0.4	0.4
0-40	29	0.7	0.7
0-60	59	1.3	1.5
0-90	79	1.8	1.9
90-120	1023	23.2	25.2
90-130	1685	38.3	41.5
90-150	3014	68.5	74.3
90-180	3977	90.4	98.1
0-180	4055	92.2	100.0

### ENERGY DATA

Total Luminaire Efficiency	92.2%
Luminaire Efficacy Rating (LER)	63
Comparative Yearly Lighting Energy Cost per 1000 Lumens	\$3.81 based on 3000 hrs. and \$0.08 per KWH

Test Date 8/30/00

## PHOTOMETRIC DATA

### LUMINAIRE DATA Test 12620

Luminaire	WMP-2T5HO-PERF-WM-E WMP Curves 6.5" x 48" 2-Lamp Wall Mount With Specular Reflector
Ballast	FWTSD-155P
Ballast Factor	0.92
Lamp	F54T5
Lumens per Lamp	4400
Watts	102
Mounting	Wall
Shielding Angle	0° = 0 90° = 0
Spacing Criterion	0° = N/A 90° = N/A
Luminous Opening in Feet	Length: 3.38 Width: 0.17 Height: 0.00

### AVG. LUMINANCE (Candela/Sq. M.)

	90.0	135.0	180.0	225.0	270.0
0	562	562	562	562	562
30	1730	1644	476	108	108
40	1859	1687	465	220	562
45	1934	1696	424	397	556
50	1953	1719	379	466	437
55	2025	1731	327	392	327
60	2061	1686	262	300	225
65	2083	1640	222	222	133
70	2136	1588	164	110	110
75	2099	1448	145	72	72
80	2158	1295	108	0	0
85	3009	1505	0	0	0

### COEFFICIENTS OF UTILIZATION (%)

RC	80					70					50					0
	RW	70	50	30	10	70	50	30	10	50	30	10	0	0		
1	69	66	63	61	59	57	55	52	39	38	37	1	0			
2	63	58	53	50	54	50	46	43	34	32	30	1	0			
3	57	51	45	41	49	44	39	36	30	28	25	1	0			
4	52	45	39	34	45	38	34	30	27	24	21	1	0			
5	48	39	33	29	41	34	29	25	24	21	18	1	0			
6	44	35	29	25	37	30	25	22	21	18	16	1	0			
7	40	31	25	21	34	27	22	19	19	16	13	0	0			
8	37	28	22	19	32	24	20	16	17	14	12	0	0			
9	34	25	20	16	29	22	17	14	15	12	10	0	0			
10	32	23	18	14	27	20	16	12	14	11	9	0	0			

### INDOOR CANDELA PLOT

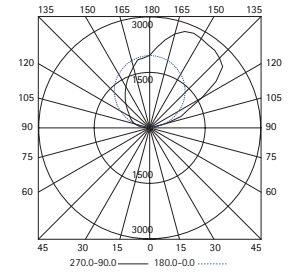

RCR = Room Cavity Ratio  
 RC = Effective Ceiling Cavity Reflectance RW = Wall Reflectance

### ZONAL LUMEN SUMMARY

Zone	Lumens	% Lamp	% Fixt.
0-30	30	0.3	0.4
0-40	54	0.6	0.8
0-60	108	1.2	1.5
0-90	148	1.7	2.1
90-120	1523	17.3	21.7
90-130	2726	31.0	38.8
90-150	5164	58.7	73.6
90-180	6872	78.1	97.9
0-180	7019	79.8	100.0

### ENERGY DATA

Total Luminaire Efficiency	79.8%
Luminaire Efficacy Rating (LER)	63
Comparative Yearly Lighting Energy Cost per 1000 Lumens	\$3.81 based on 3000 hrs. and \$0.08 per KWH

Test Date 8/8/00